



TL311-020 Series

- Rated Input: AC100V - 240V 50Hz/ 60Hz
- No Load Input Power : <300mW
- CLASS II – Reinforced Insulation Designed
- Insulation Class: B (130°C)
- Flammability : UL94V0
- Dielectric Strength: 3000VAC
- Ambient temperature (ta) -25°C - +40°C
- Storage temperature : -40°C - +85°C
- Potted under vacuum
- Short circuit protected
- CE marked

Safety: EN61558-1/EN61558-2-16 / EN60950-1
(R 50275524)

EMC: EN55024 / EN55022 / EN61000-3-2/3
(R 50275530)

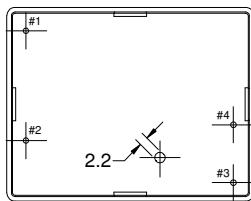

Bottom View

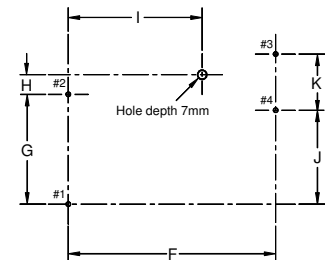
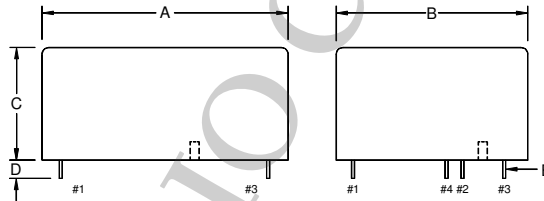

Footprint detail
Top View

Pin #1 AC(L) & #2 AC(N) and DC Pin #3 DC Output +V ; Pin #4 DC Output 0V

Product Series	Dimension (mm)											Weight (g)
	A	B	C	D	E	F	G	H	I	J	K	
TL311-020	54.4	42.5	25.3	4.0	1.0	45.7	24.1	4.3	29.5	20.6	12.7	120
Tolerance	±0.5	±0.5	±0.5	±0.5	±0.1	±0.5	±0.5	±0.5	±0.5	±0.5	±0.5	approx.

Part Number	Output Voltage (DC Volt)	Output Current (DC mA) max.	Output Power (W) max.	Regulation (%)	Ripple & noise (mV)	Efficiency (%)
TL311-020S05	5	4000	20	3	100	≥83
TL311-020S09	9	2200	20	3	100	≥83
TL311-020S12	12	1667	20	3	150	≥82
TL311-020S15	15	1333	20	3	150	≥83
TL311-020S18	18	1111	20	3	150	≥83
TL311-020S24	24	833	20	3	150	≥83

Note: under no-load & full load condition, the output voltage tolerance is ±5%

DIN RAIL Module Option (suffix -DM)

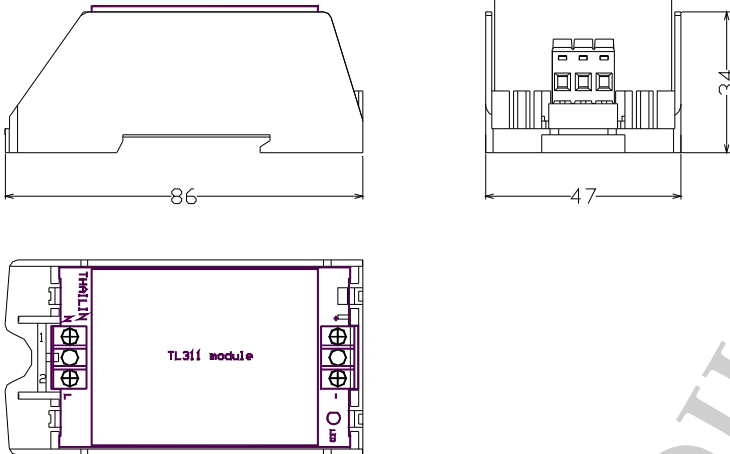

Pin Connections

Pin #	TL311 module
1	VAC in (N)
2	VAC in (L)
3	+VDC Out
4	-VDC Out